

# LACOMET<sup>®</sup> FL

## aluminium bladlood

### Vouwwijzer toepassing loket

#### 1 Verhoudingen loket toepassing

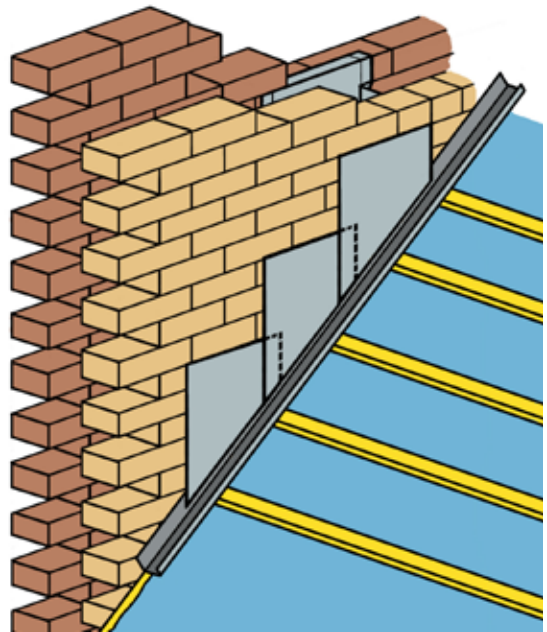
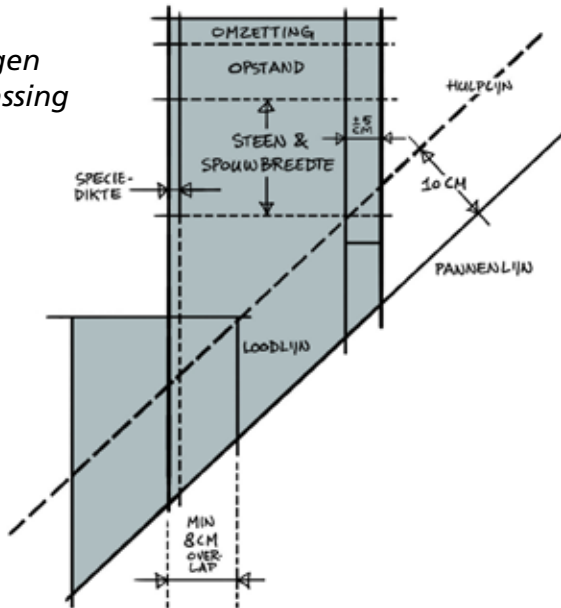

#### 2 Vorm knippen / loket vouwen

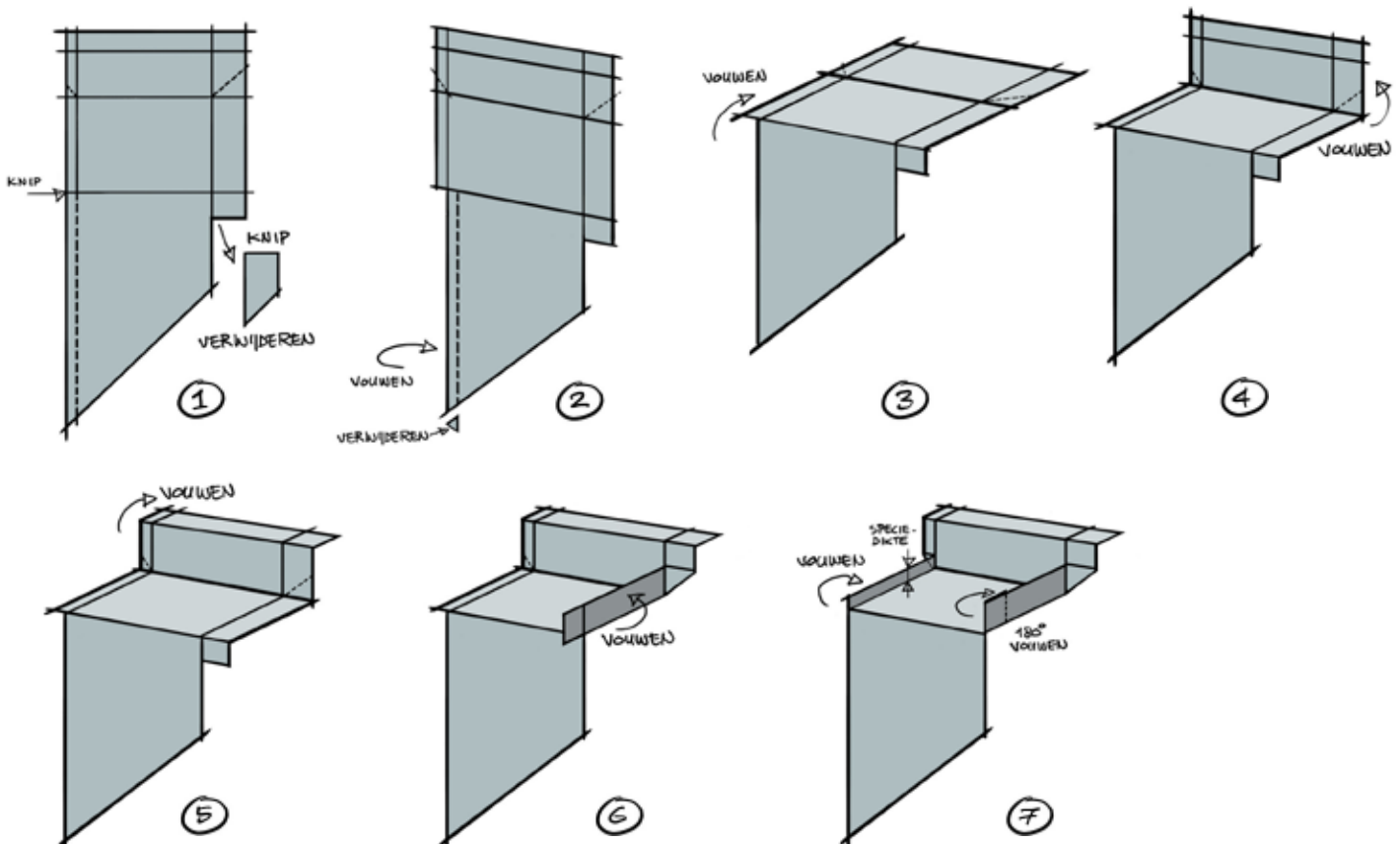

1 Loket plaatsen in spouwmuur

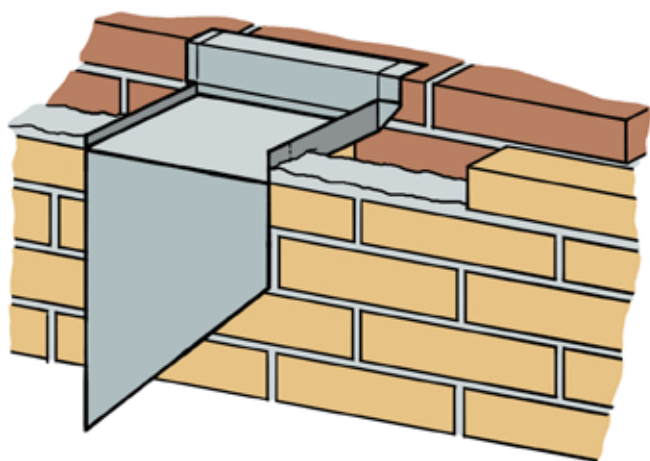

2 Plaatsen tussenschot 'binnen' loket

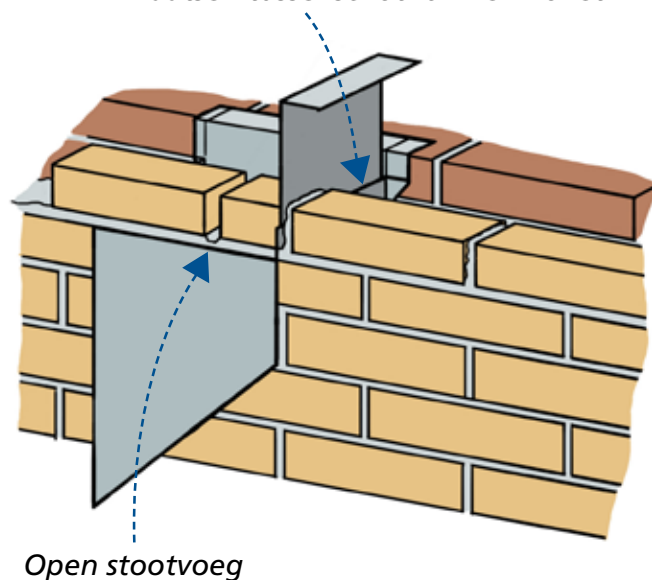

3 Doorzetten metselwerk

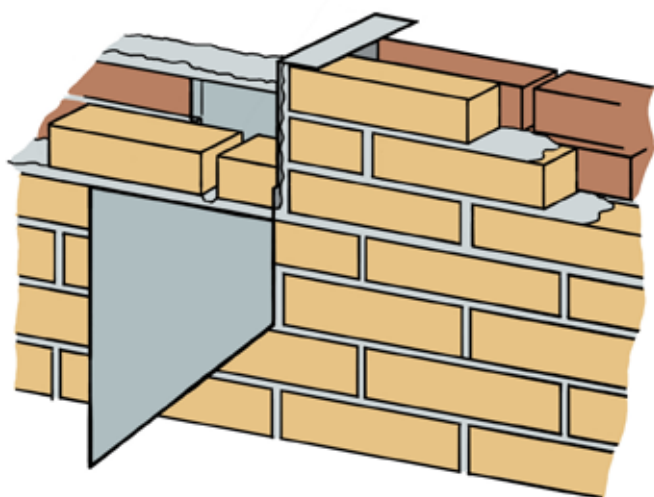

4 Loketten min. 8 cm laten overlappen

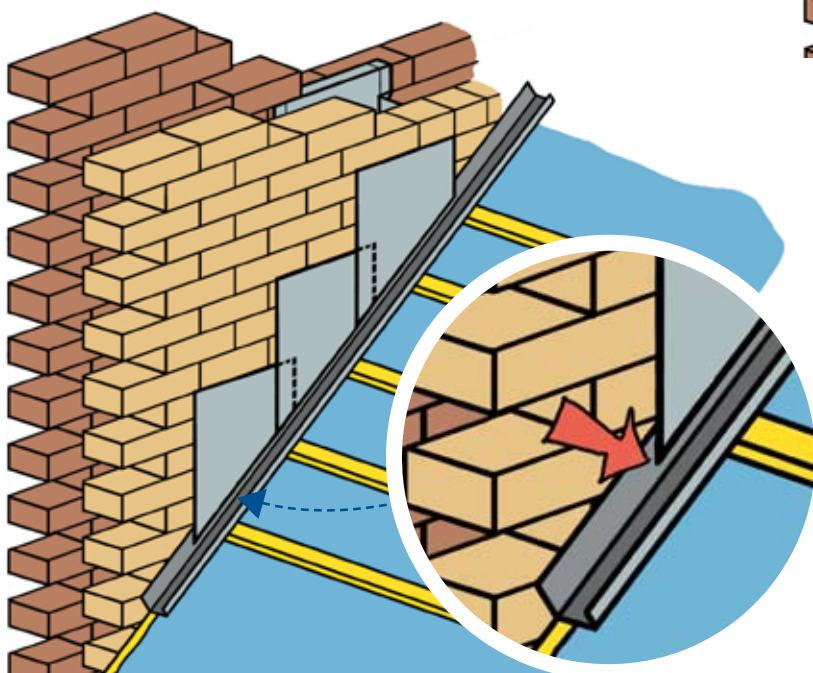
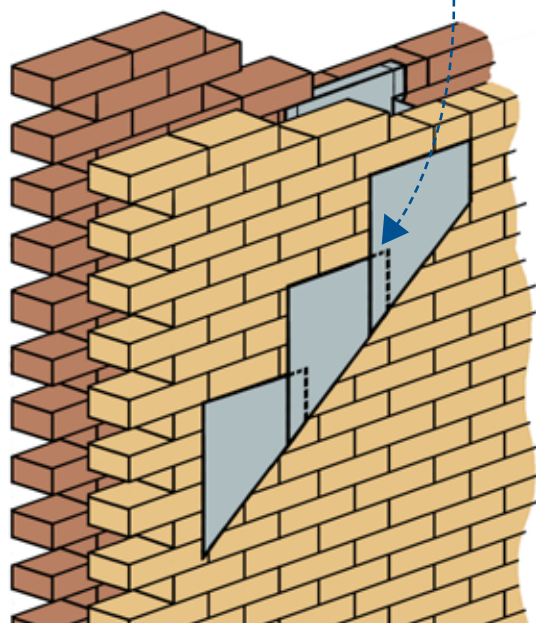

9 Loketten plaatsen in de Lacomet kilgoot



**REPPel** bv

**BOUWSPECIALITEITEN**

- Postbus 102 • 3300 AC Dordrecht
- Pieter Zeemanweg 107
- Industrieterrein Dordrecht West
- Telefoon : 078 - 617 44 00
- Telefax : 078 - 617 10 06
- E-mail : reppel@reppel.nl
- Website : www.reppel.nl