

## HODY® 60 – constructie details

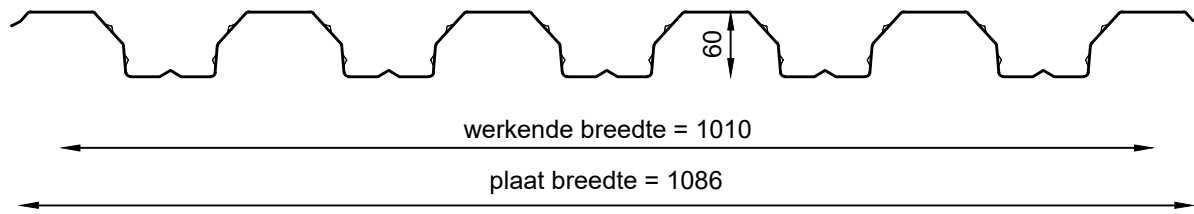

HODY® 60 staalplaatbetonvloer

beschikbare staaldiktes:

0,75, 0,88 en 1,00 mm

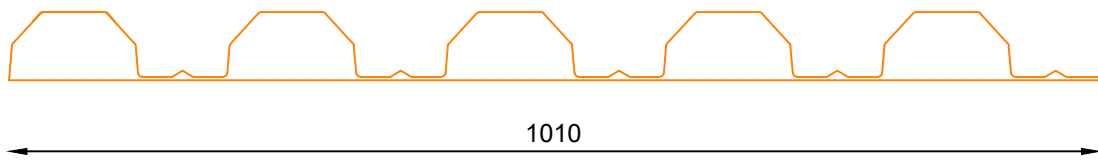

HODY® 60 cannellure afdichtingsprofiel (PE)

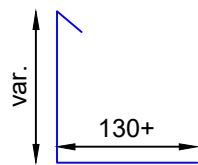

HODY® 60 randkist

L = 3000 mm

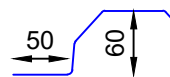

HODY® 60 randprofiel

L = 3000 mm

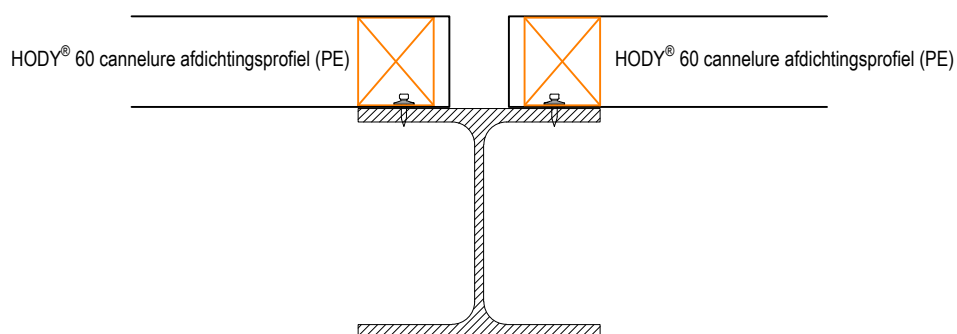
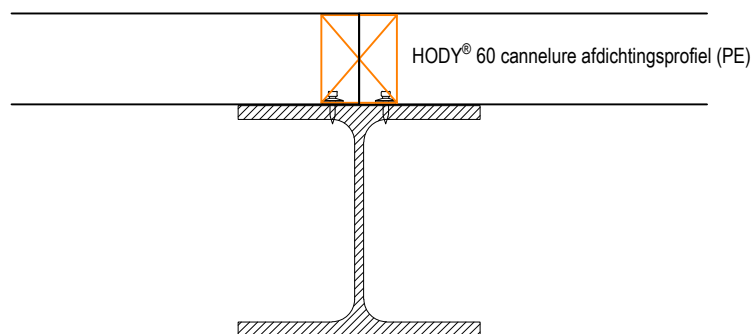

## HODY® 60 - langsoverlap

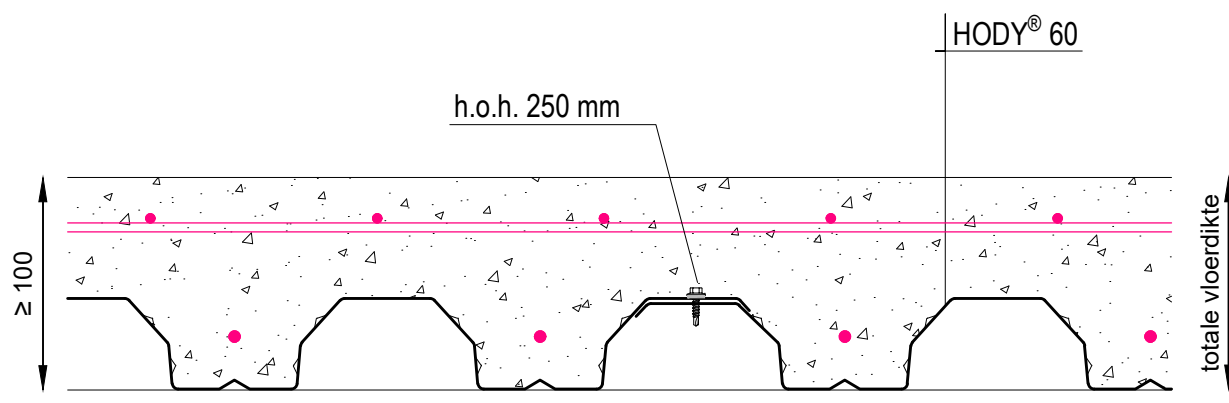

## HODY® 60 - tussenoplegging

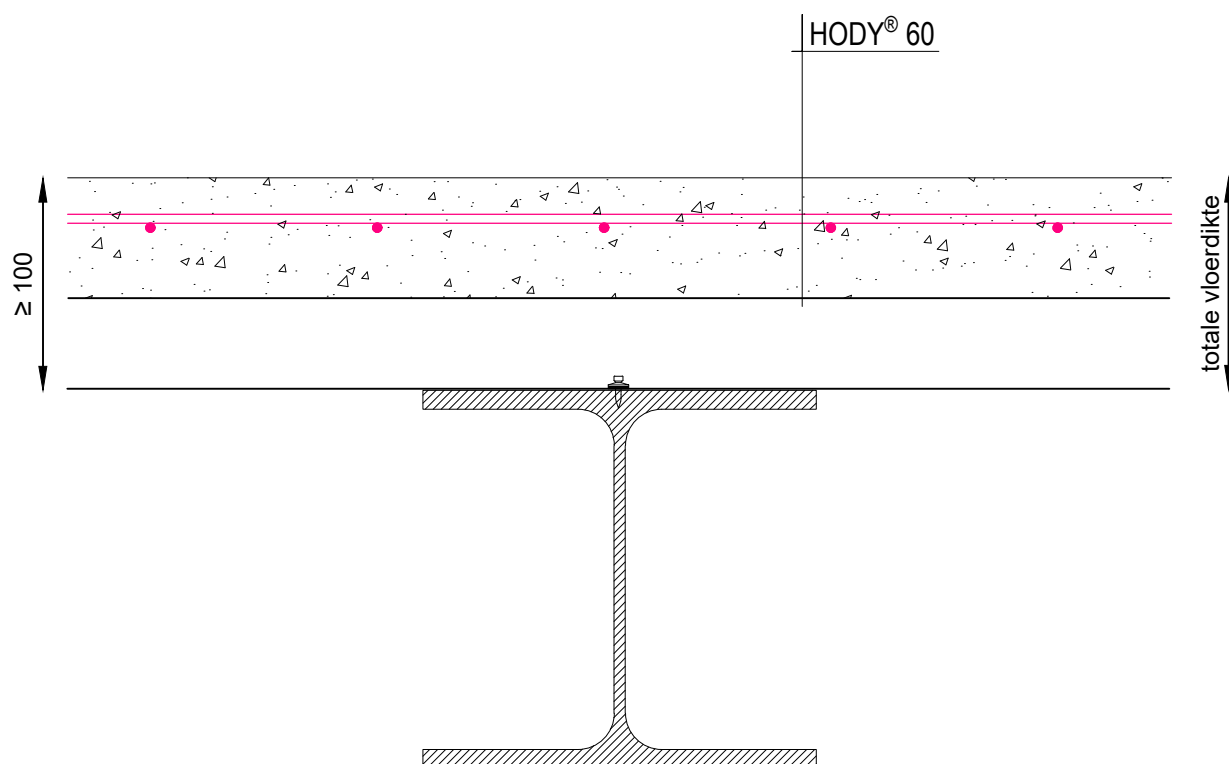

## HODY® 60 - detail 1 (eindoplegging met randkist)

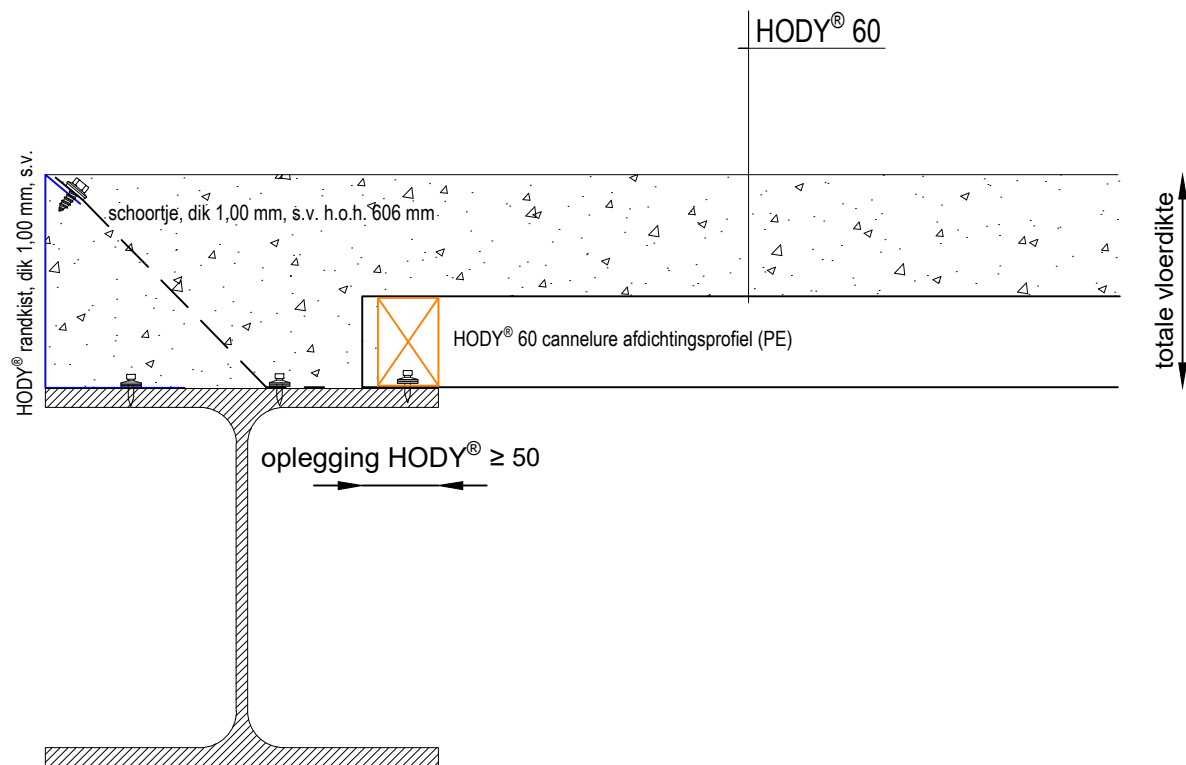

## HODY® 60 - detail 2 (langsoplegging met randkist en randprofiel)

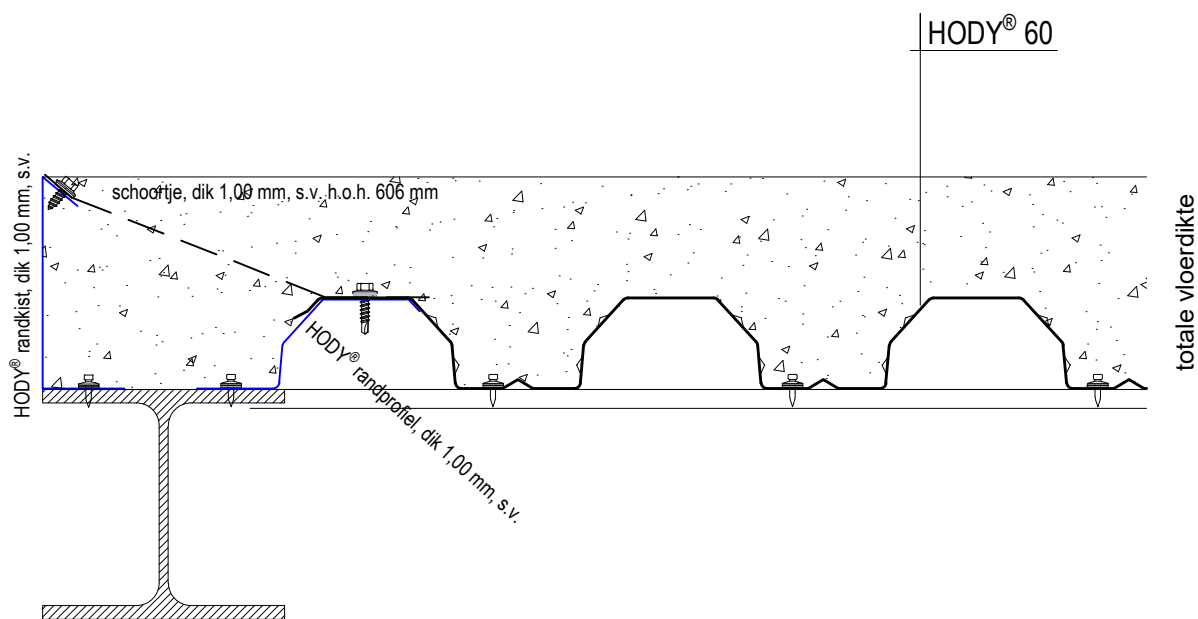

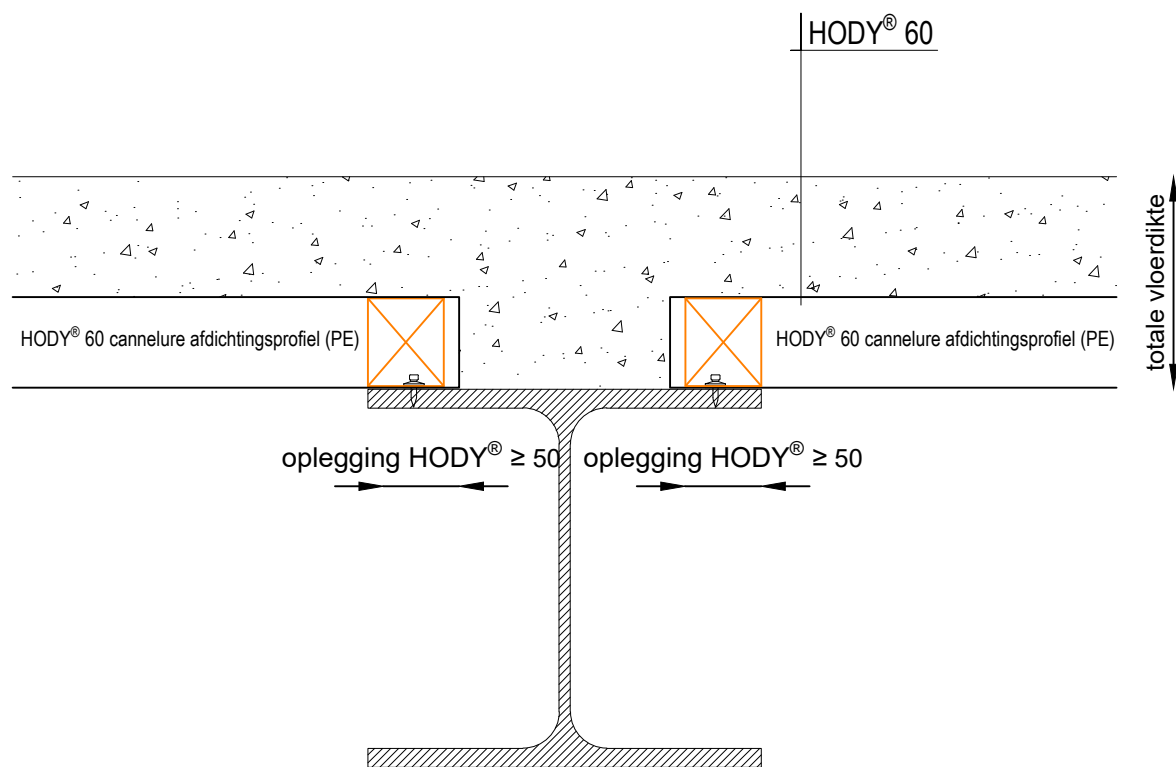
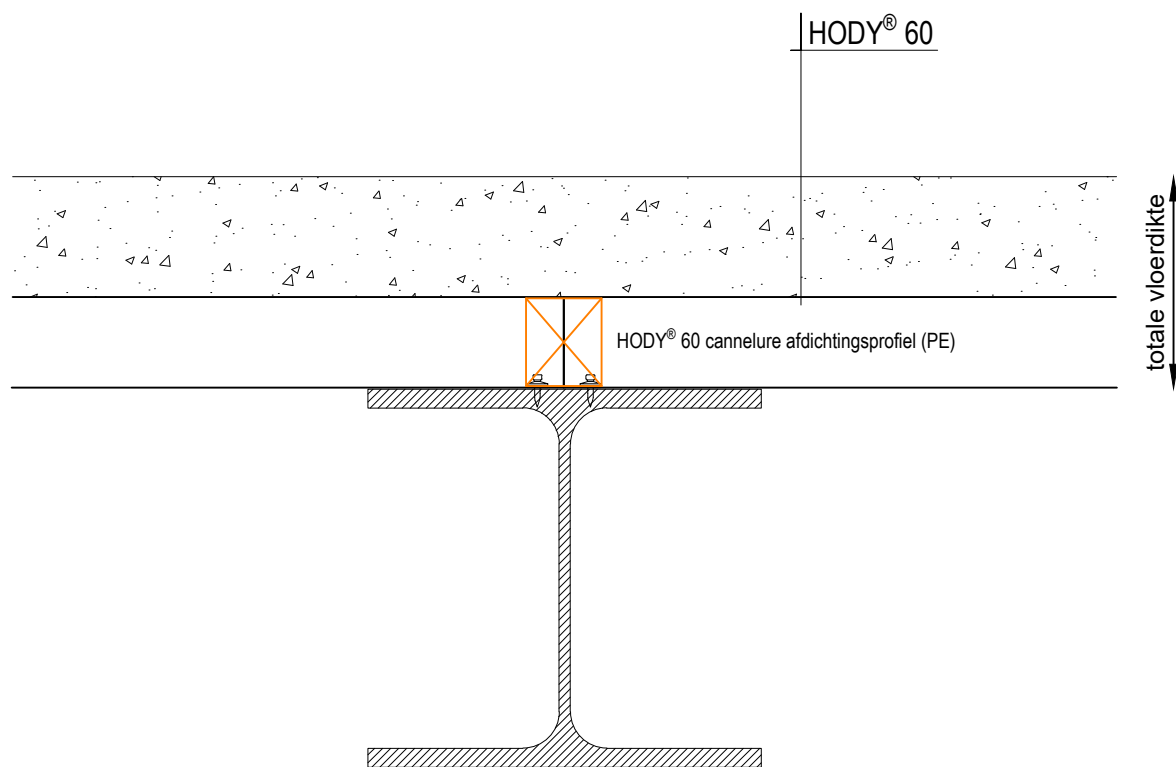

## HODY® 60 - detail 4 (verhoogde tussenoplegging)

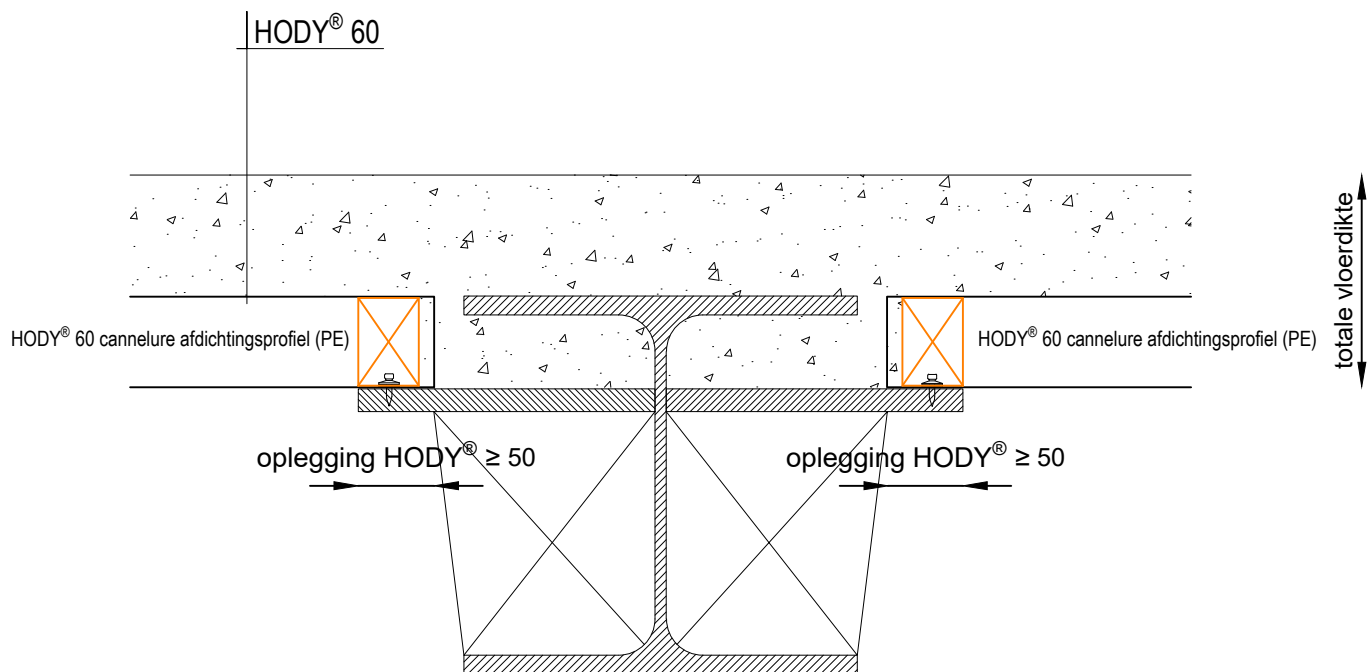

## HODY® 60 - detail 5 (eindoplegging tussen de liggers)

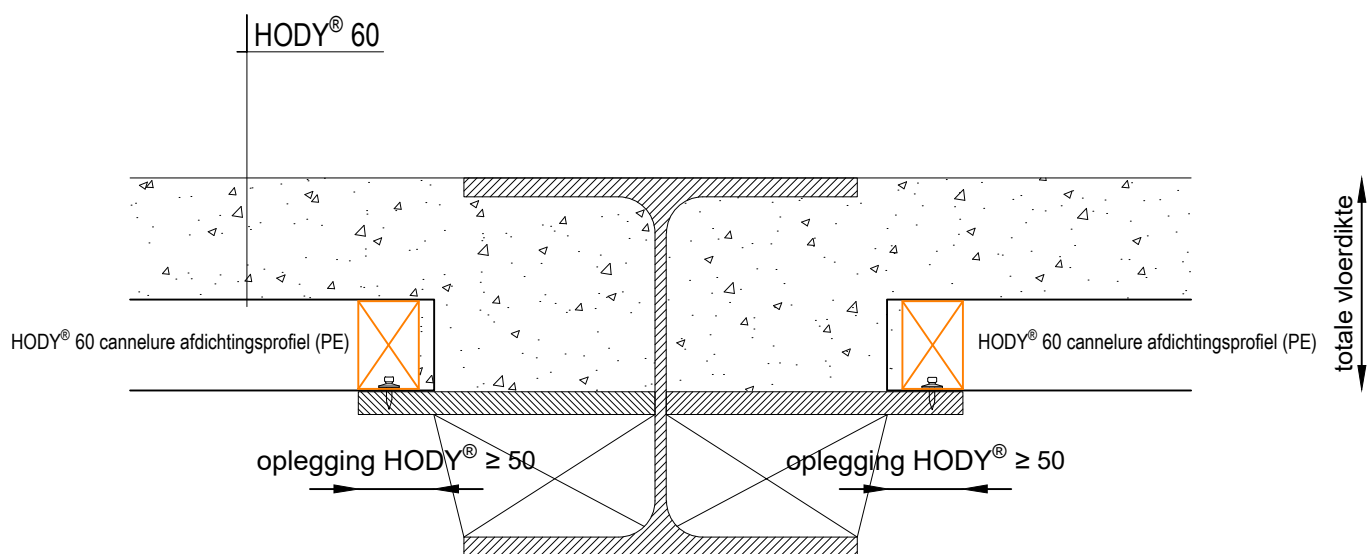

## HODY® 60 - detail 6 (eindoplegging met randkist)

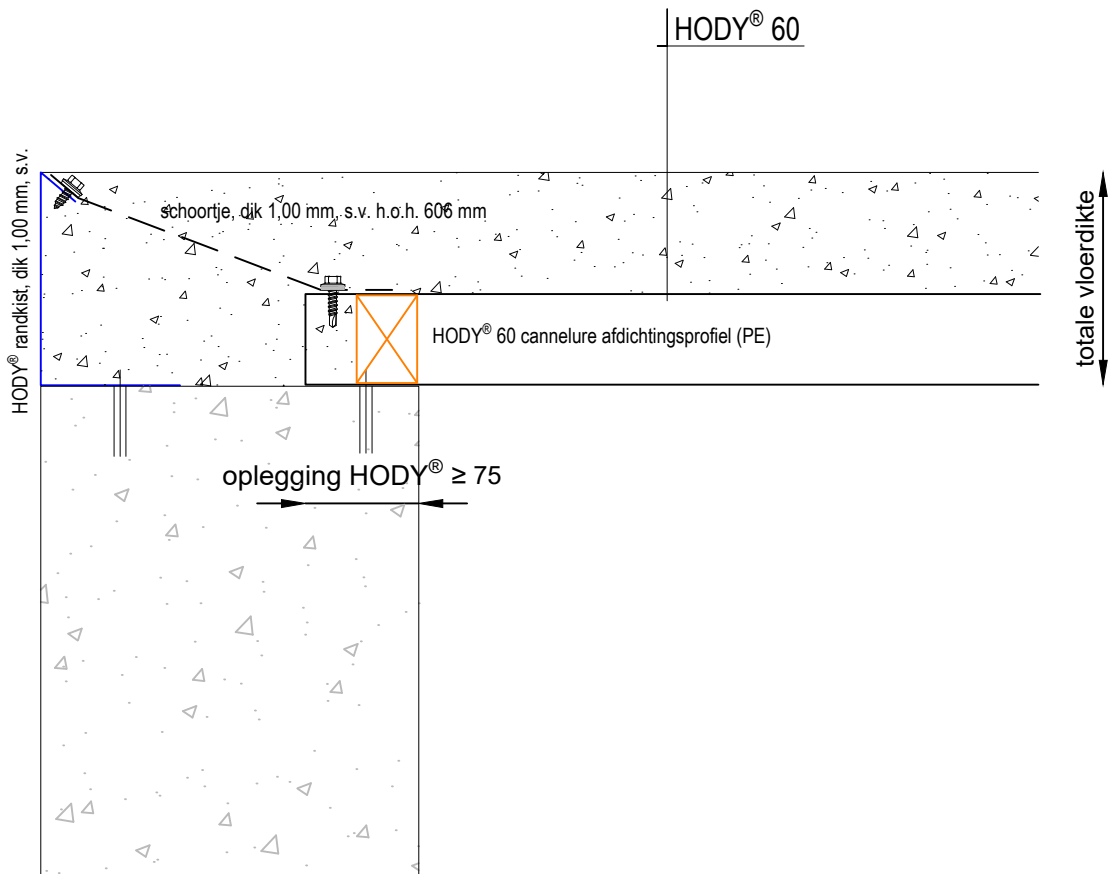

## HODY® 60 - detail 7 (langsoplegging met randkist en randprofiel)

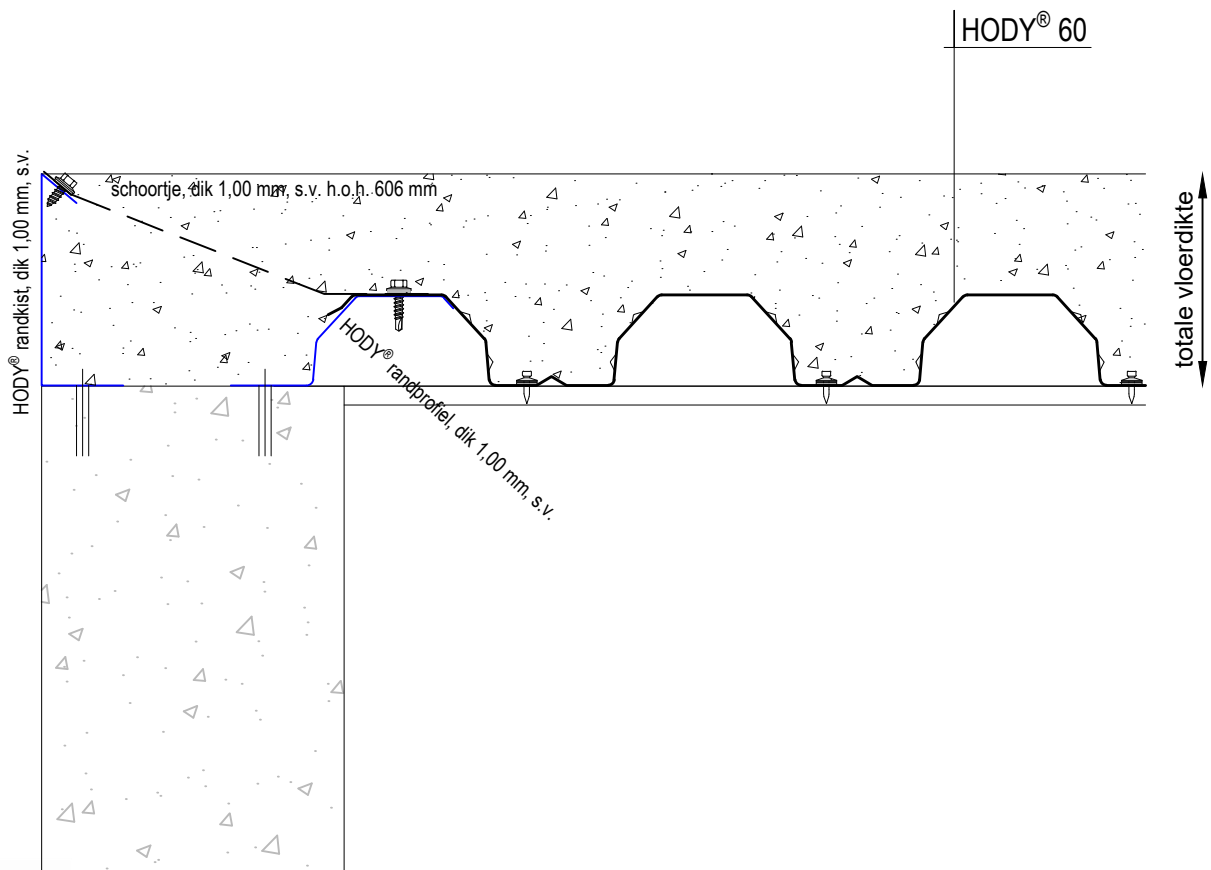

## HODY® 60 - detail 8 (langsoplegging met randkist, onderstempeld)

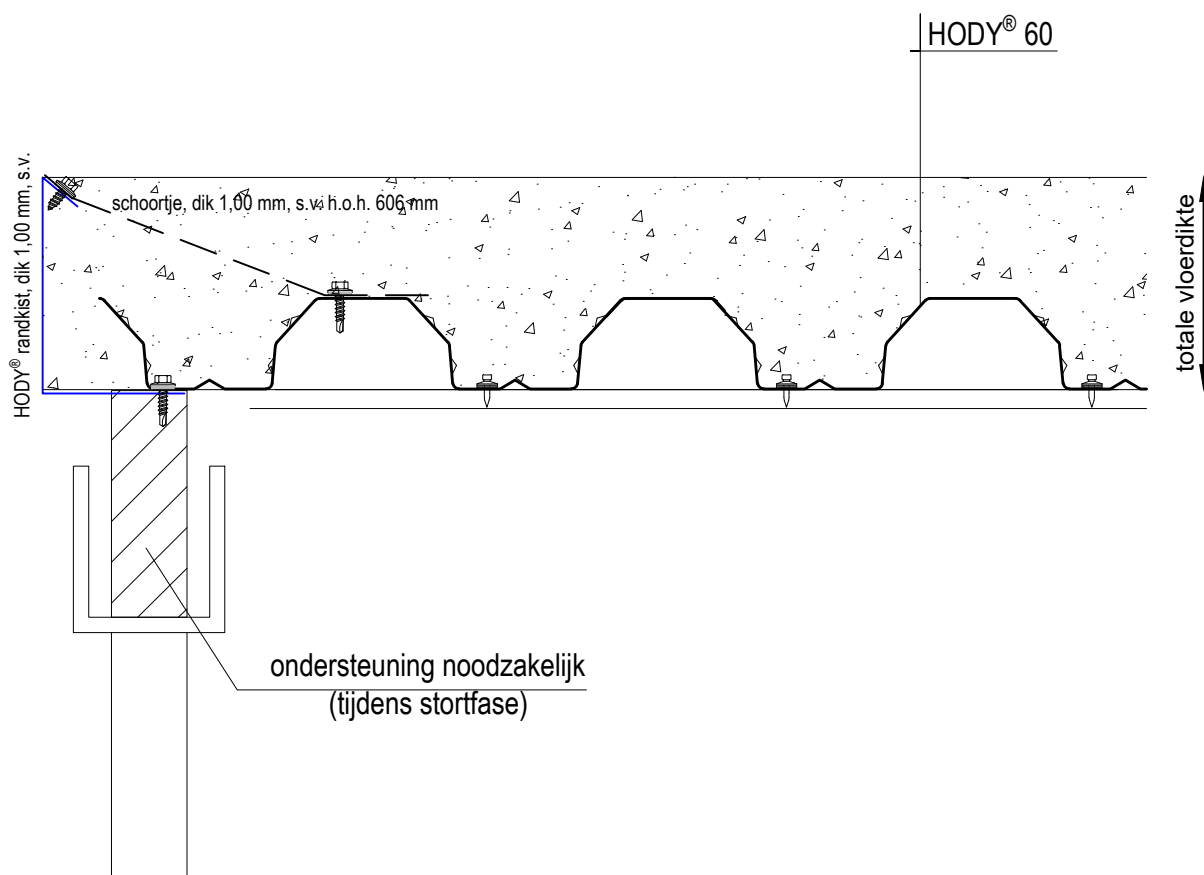

## HODY® 60 - detail 9 (langsoplegging met randkist, onderstempeld)

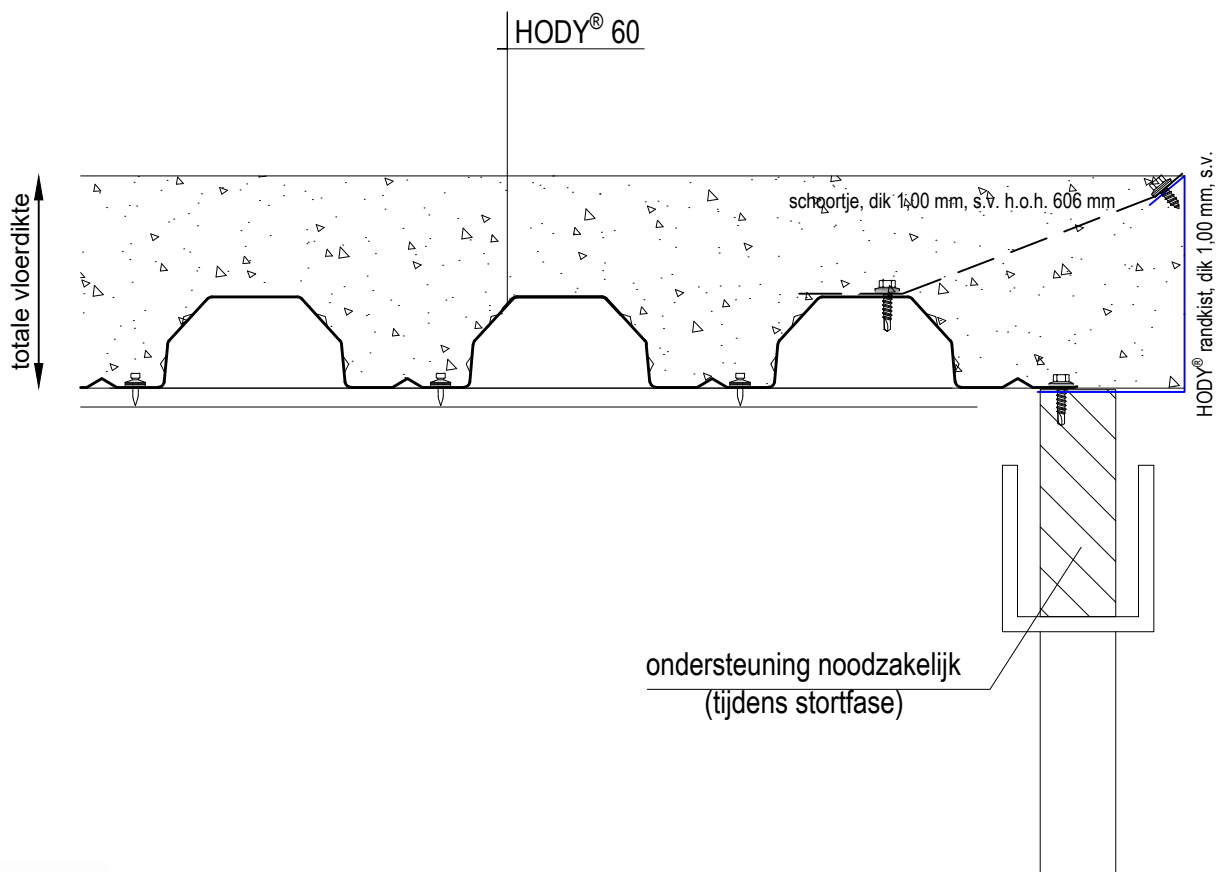



## HODY® 60 - detail 10 (langsoplegging met randkist)

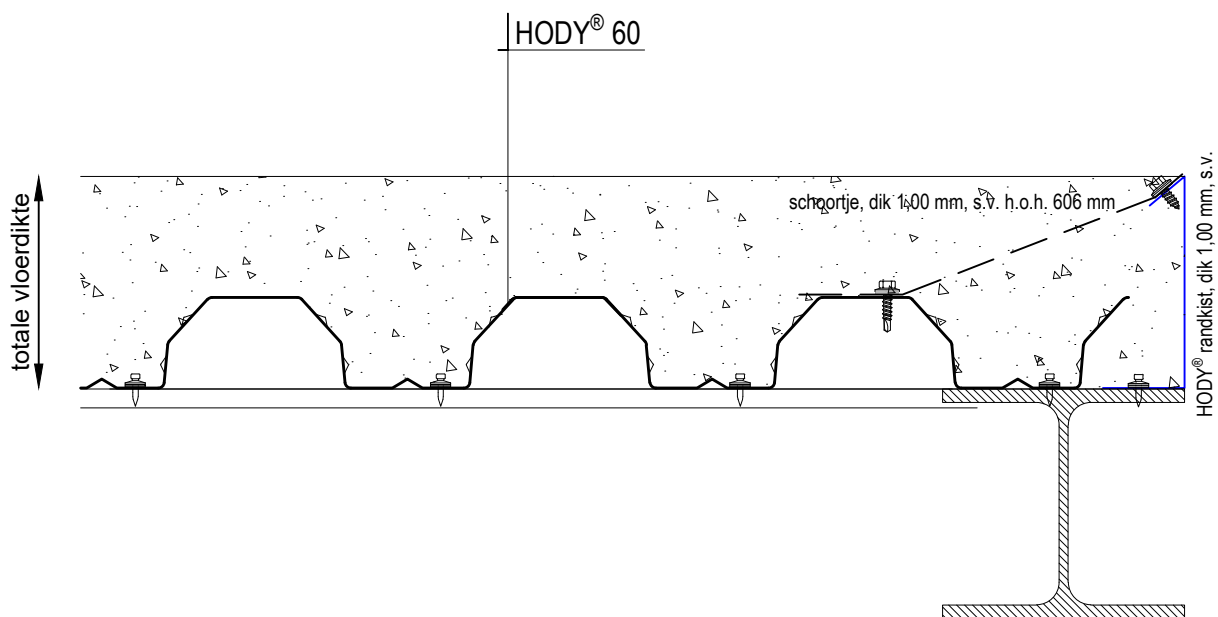

## HODY® 60 - detail 11 (langsoplegging)

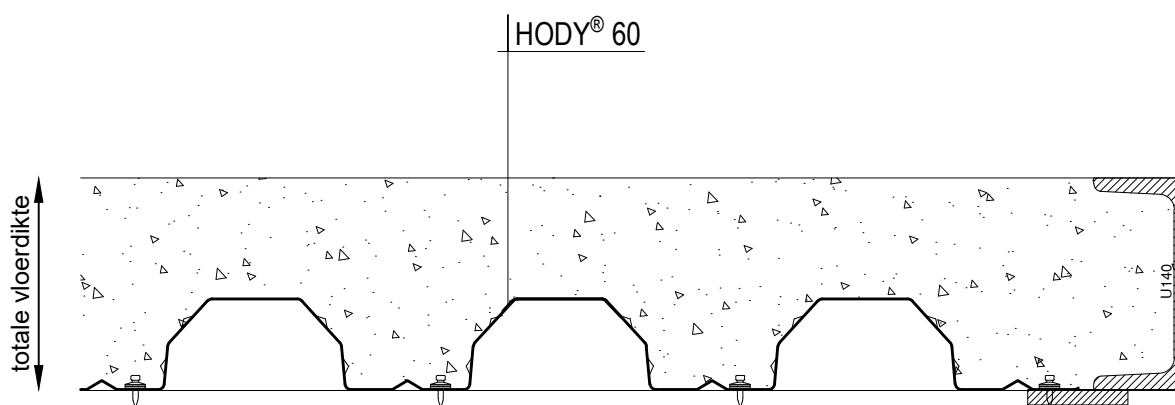

## HODY® 60 - detail 12 (eindoplegging)

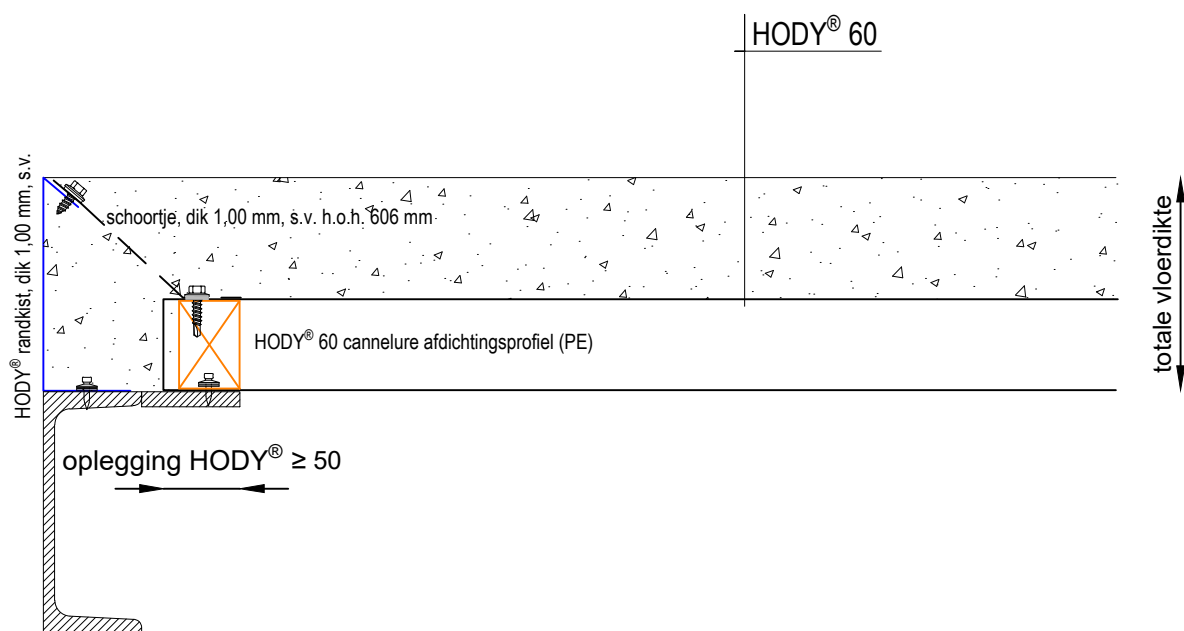

## HODY® 60 - detail 13 (langsoplegging)

